

Designed JSK 08/07/16

Drawn JSK 08/07/16

All dimensions in mm

Notes:

Must be used in conjunction with T&R's seismic system and not to be used with any other grid and/or system.

Not to be used as a substitute for engineering advise.

Title: TRS-001

Generic Floating Edge Detail, 24mm CBI Grid

Project: Seismic Detail

Scale: NTS

Tek screws or fixing as per non load bearing wall trim specification

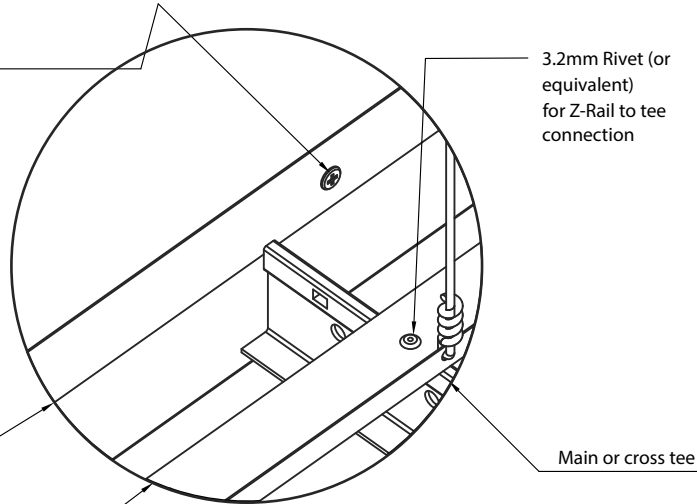

T&R Z-Rail Floating Edge Isometric

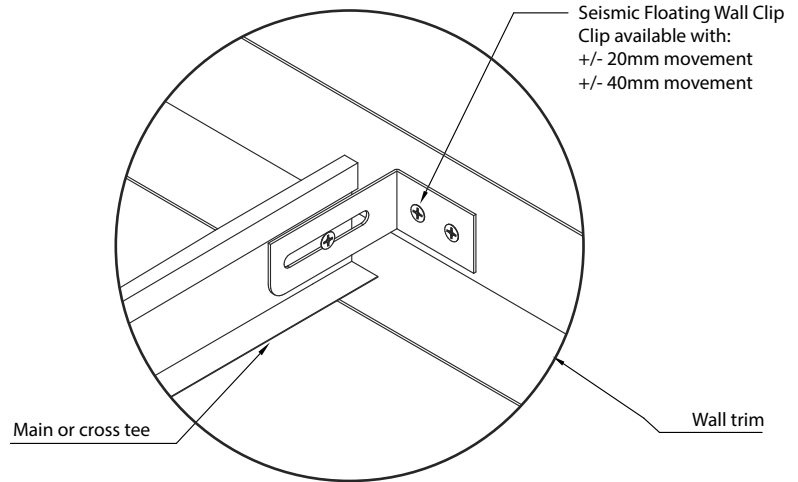

Seismic Clip Wall Edge Isometric

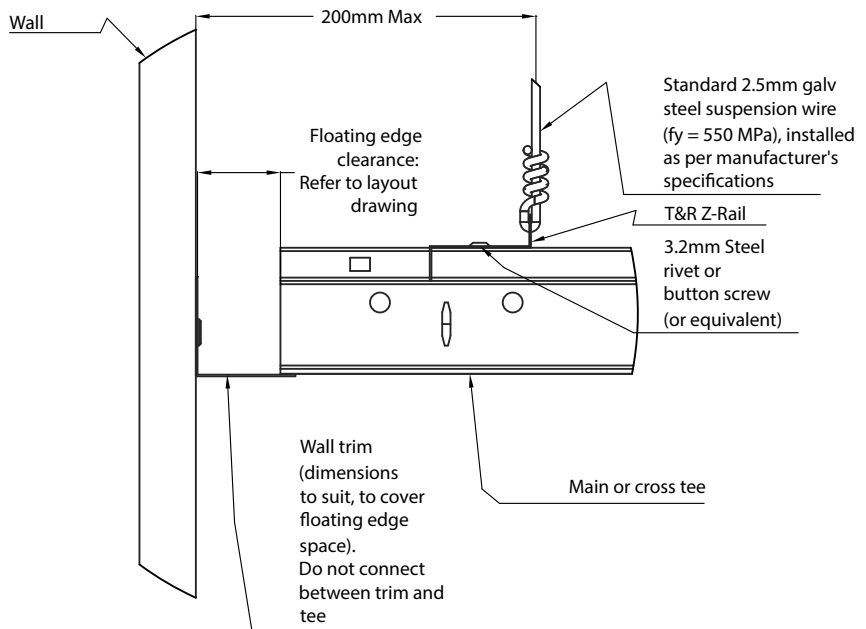

Floating Edge Detail

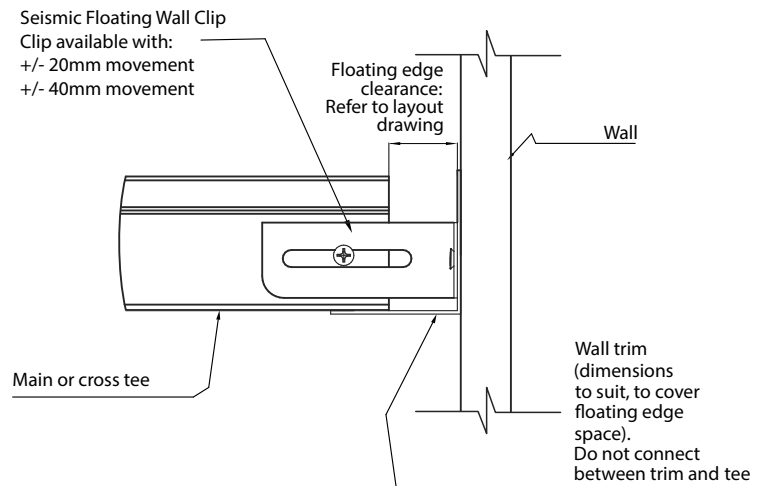

Seismic Clip Wall Edge Detail

Designed T&R 28/11/19

Drawn T&R 28/11/19

All dimensions in mm

Notes:

Must be used in conjunction with T&R's seismic system and not to be used with any other grid and/or system.

Not to be used as a substitute for engineering advise.

Title: TRS-001
Seismic Fixed
Edge Detail, 24mm CBI
Grid

Project: Seismic Detail

Scale: NTS

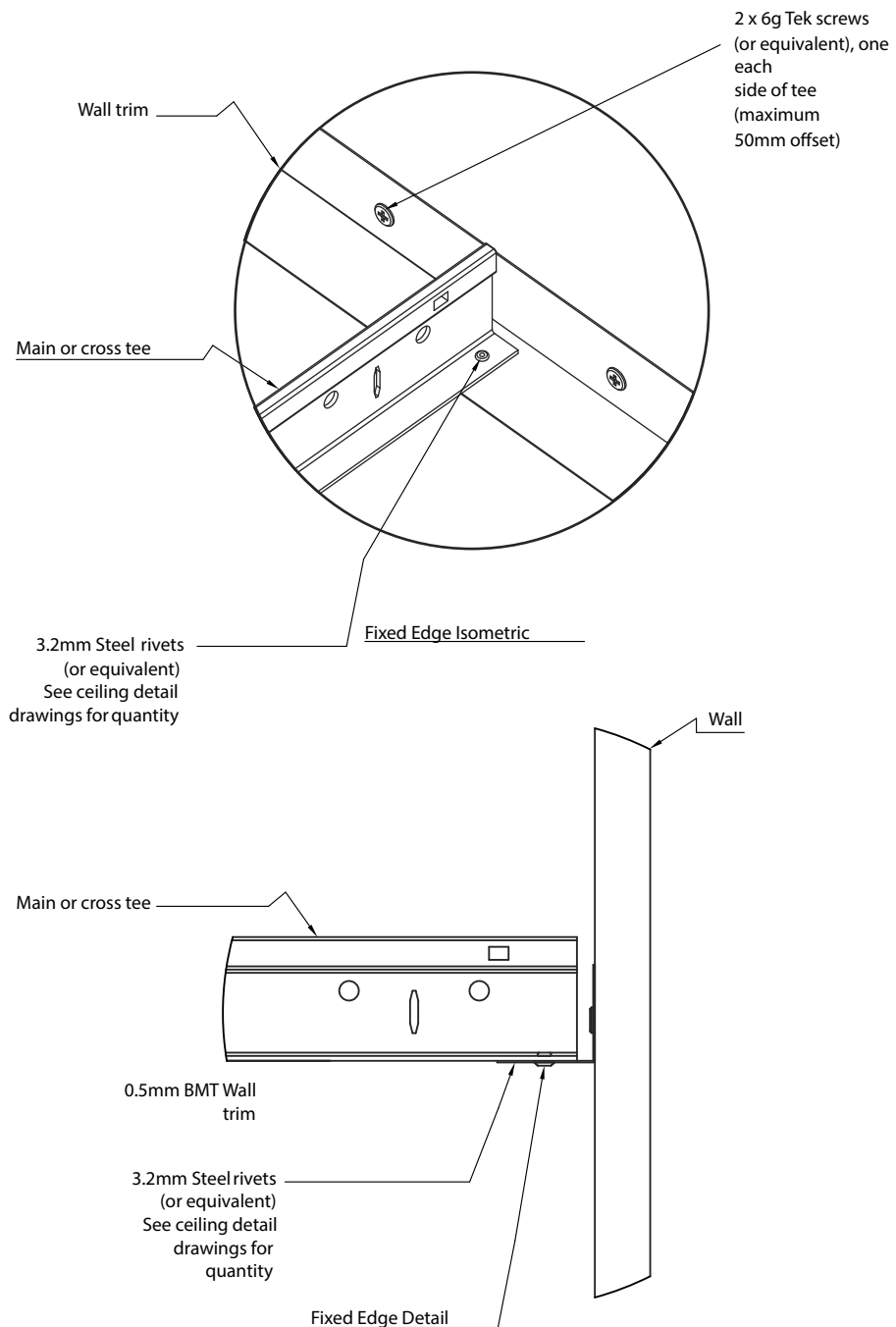

Note: Walls are to be fitted with a continuous dwang at ceiling height on walls where edge fixing is required, as per T&R seismic design guide.

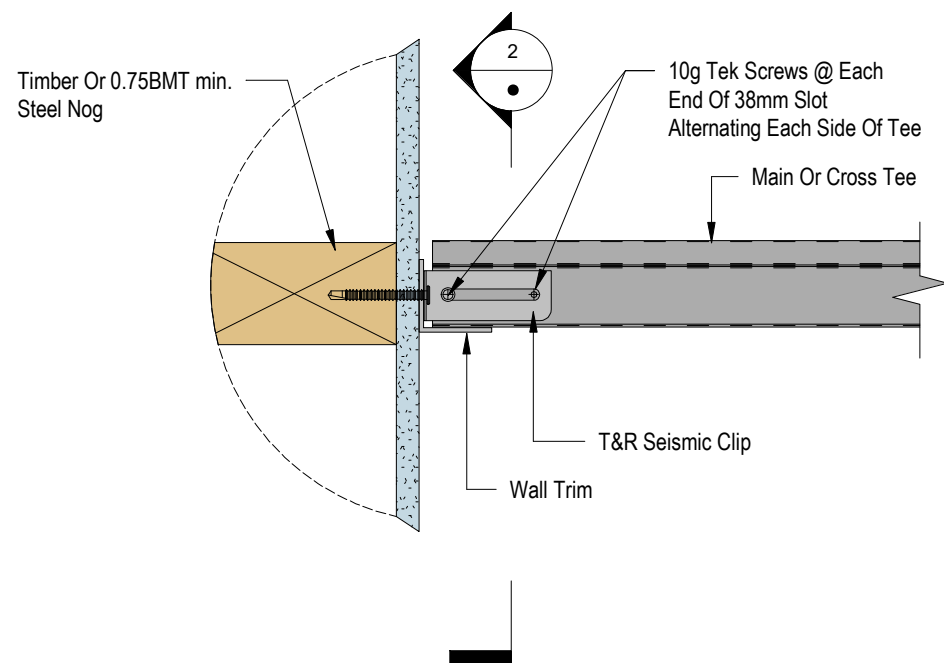

1 FIXED EDGE ELEVATION

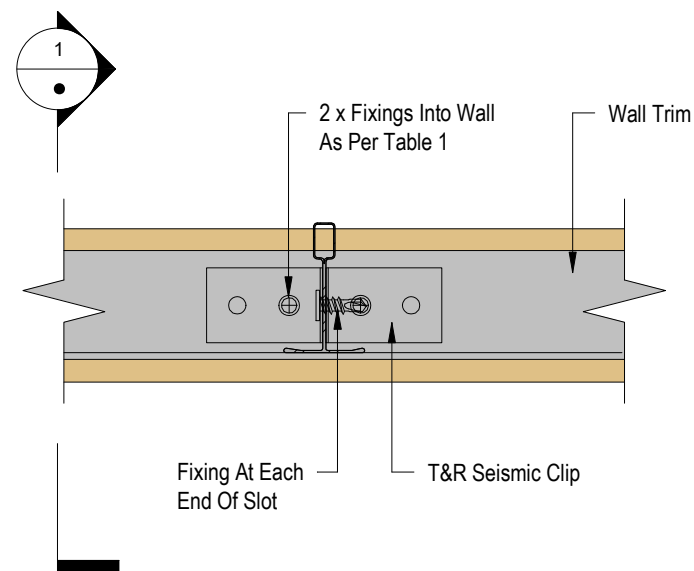

2 FIXED EDGE SECTION

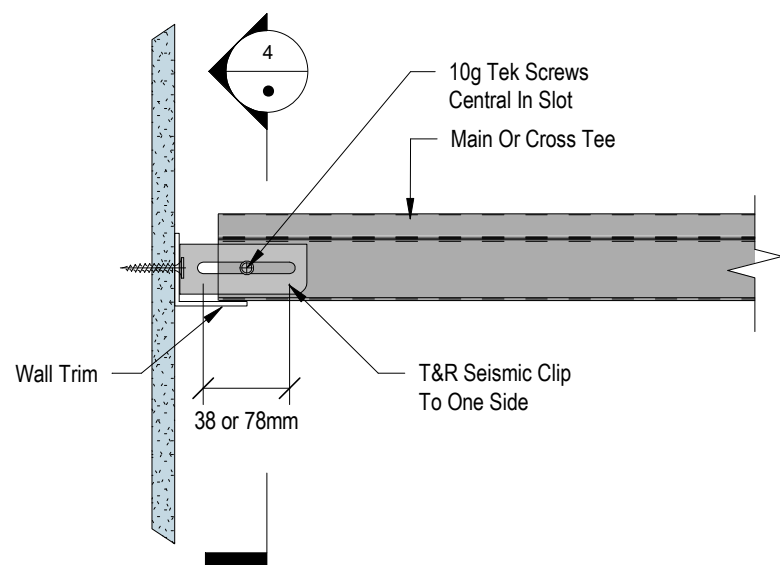

3 FLOATING EDGE ELEVATION

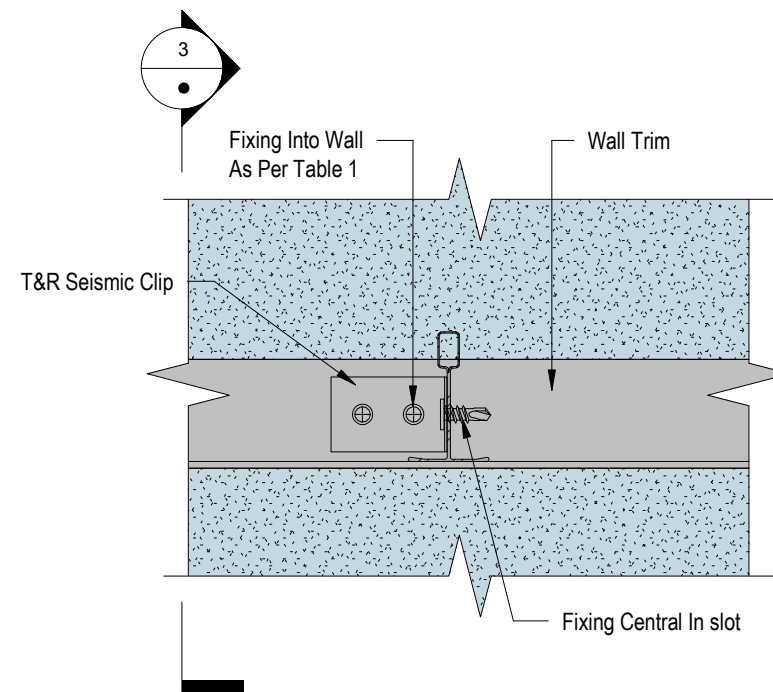

4 FLOATING EDGE SECTION

TABLE 1: FIXINGS

STEEL STUD	10g Tek Screws
TIMBER	8g T17 HWF Screws - 35mm Embedment

FIXED EDGE CAPACITY

ULS	-	80kg
SLS2	-	80kg
SLS1	-	45kg

NOTE:

- Minimum Stud/Nog Thickness For Steel Stud Walls Is 0.75mm BMT. For 0.55mm BMT Studs, A Reduced ULS & SLS2 Capacity Of 57.4 kg Applies.
- Walls With Ceiling Fixed Edges Must Have Sufficient Capacity To Withstand Ceiling Loads

DESIGNED:	TM	28/09/2021
DRAWN:	CF	28/09/2021
CHECKED:	TM	28/09/2021
REVIEWED:		
PROJECT NUMBER:	6077	
REV:	DATE:	DESCRIPTION:
A	29/09/21	Release